

Public Document Pack

**THESE MINUTES REMAIN DRAFT UNTIL FORMALLY APPROVED AT
THE 2 DECEMBER 2013 MEETING**

Minutes of the meeting of the
REIGATE AND BANSTEAD LOCAL COMMITTEE
held at 2.00 pm on 16 September 2013
at Reigate Town Hall, Castlefield Road, Reigate, Surrey RH2 0SH.

Surrey County Council Members:

- * Mrs Dorothy Ross-Tomlin (Chairman)
- * Mrs Kay Hammond (Vice-Chairman)
- * Mrs Natalie Bramhall
- * Mr Jonathan Essex
- Mr Bob Gardner
- * Mr Michael Gosling
- * Dr Zully Grant-Duff
- * Mr Ken Gulati
- * Mr Nick Harrison
- Ms Barbara Thomson

Reigate and Banstead Borough Council Members:

- Cllr Victor Broad
- Cllr Adam De Save
- Cllr Julian Ellacott
- * Cllr Ms Sarah Finch
- Cllr Norman Harris
- * Cllr Roger Newstead
- * Cllr Graham Norman
- Cllr David Powell
- * Cllr John Stephenson
- Cllr Mrs Rachel Turner

* In attendance

43/13 APOLOGIES FOR ABSENCE (AGENDA ITEM ONLY) [Item 1]

Apologies for absence were received from Mr Bob Gardner, Ms Barbara Thomson, Cllr Victor Broad, Cllr Adam De Save, Cllr Julian Ellacott and Cllr Mrs Rachel Turner.

44/13 MINUTES OF PREVIOUS MEETING (AGENDA ITEM ONLY) [Item 2]

The minutes were agreed as a true and accurate record of the meeting.

45/13 DECLARATIONS OF INTEREST (AGENDA ITEM ONLY) [Item 3]

There were no declarations of interest.

46/13 PETITIONS (AGENDA ITEM ONLY) [Item 4]

Two petitions were received.

47/13 PETITION - CARSHALTON ROAD, WOODMANSTERNE [Item 4a]

The Committee received a petition signed by 84 residents, requesting that Surrey County Council put in place a zebra crossing for school children on Carshalton Road, Woodmansterne.

The Committee **NOTED** the response of the Area Team Manager.

48/13 PETITION - SOMERS ROAD, REIGATE [Item 4b]

A petition was presented by Mrs Katrina Millard, signed by 249 residents, calling for safety measures in Somers Road, Reigate.

The Committee **NOTED** the response of the Area Team Manager.

49/13 FORMAL PUBLIC QUESTIONS (AGENDA ITEM ONLY) [Item 5]

Three formal public questions/statements were received. Responses were tabled and are attached to the minutes as **Appendix A**.

[Professor Swanson asked a supplementary question. He wished to know whether Surrey County Council should routinely ask local Members to contribute to planning consultations. The Area Team Manager responded that all Members receive lists of planning applications, and if members of the public had an issue with an application, they should contact their local Member.

In Mr Parks' absence, Mr Ken Gulati reiterated that he was only seeking agreement in principle to the proposed 20mph zone.

Mrs Straker asked a supplementary question. She wished to know how a parking restriction between 10am and 11am would help the problem of congestion later in the day. If a one hour per day restriction was the only option, she wished to know if this could be between 2pm and 3pm instead. The Parking Team Manager responded that a longer restriction had originally been advertised but this had received many objections, particularly from parents of children attending Micklefield School. He offered to change the restriction to 2pm – 3pm as requested, and was happy to meet with residents, along with the divisional Member.]

50/13 FORMAL MEMBER QUESTIONS (AGENDA ITEM ONLY) [Item 6]

One Member question was received from Ms Barbara Thomson. A response was tabled and is attached to the minutes as **Appendix B**. This was noted in Ms Thomson's absence.

51/13 LOCAL COMMITTEE TASK GROUP REPRESENTATION 2013-14 - VACANCIES [NON-EXECUTIVE FUNCTION] [Item 7]

No nominations were received for the vacancies on the Local Sustainable Transport Task Group and the Youth Task Group. These task groups will therefore continue with the membership as set out in the report submitted.

**52/13 LOCAL COMMITTEE AND MEMBERS' ALLOCATION FUNDING - UPDATE
[FOR INFORMATION ONLY] [Item 8]**

Resolution:

The Committee **NOTED** the amounts that have been spent from the Members' Allocation (revenue) and Local Committee capital budgets, as set out in Annexes 1 and 2 of the report submitted.

**53/13 REIGATE AND BANSTEAD PARKING REVIEW - RESPONSE TO
STATUTORY CONSULTATION [EXECUTIVE FUNCTION] [Item 9]**

Declarations of Interest: None

Officers attending: David Curl, Parking Strategy and Implementation Team Manager, and Adrian Harris, Engineer, Parking Team

Petitions, Public Questions, Statements: One question (dealt with under Item 5)

Member Discussion – key points:

- The Parking Team Manager explained that there had been a number of late responses to the proposals in Josephine Avenue and Buckland Road, Lower Kingswood, on the grounds that the double yellow lines would make it harder to access the church. The Parking Team Manager accepted these comments but was in agreement with the divisional Member that the proposals should go ahead as advertised because: obstructive parking was an issue on Sundays, not just Monday-Friday; wedding and funeral cars can park on waiting restrictions; loading is permitted on waiting restrictions (except where there are loading restrictions); Blue Badge holders can park for 3 hours on waiting restrictions; there is a church car park within 100 yards and ample parking in Josephine Avenue; this is a safety issue near the junction with the A217.
- Concerns were raised regarding the introduction of double yellow lines at Shaw's Corner, Redhill; the Redhill United Reformed Church has no car park and users of the church, including community groups have to park on street. The Parking Team Manager agreed to look into this.
- Members wished to know when a permit scheme would be introduced in Grovehill Road, Redhill. The Parking Team Manager replied that the Redhill Parking Task Group would be looking into this, and the first meeting would be convened shortly.
- Support was expressed for the proposals in Garden Close, Banstead and Lynden Gardens, Reigate.
- Concerns were expressed that parking restrictions would displace problem parking elsewhere, given that parking was permitted on unrestricted residential roads.

Resolution:

The Committee **AGREED:**

- (i) The proposals and recommendations in Annex 1 to the report submitted, some amended following statutory consultation.
- (ii) That where necessary, the Parking Team Manager, in consultation with the Chairman, Vice-Chairman and local Member, make any necessary adjustments to the proposals following the meeting.
- (iii) That the County Council make an Order under the relevant parts of the Road Traffic Regulation Act 1984 to impose the waiting and on street parking restrictions in Reigate and Banstead as shown in the Annex to the report submitted (and as subsequently modified by (ii)).
- (iv) That the existing text based parking traffic regulation orders are converted to plan based orders.
- (v) That the waiting and loading restrictions proposed for the Redhill Balanced Network are implemented 'as advertised'.

[A revised drawing no. 18012 was tabled, replacing p.112 in the original agenda pack, and is attached to the minutes as **Appendix C.**]

54/13 SURREY FIRE AND RESCUE SERVICE ANNUAL REPORT 2012-13 [FOR INFORMATION ONLY] [Item 10]

Declarations of Interest: None

Officers attending: Eddie Roberts, Area Manager East and Stuart de Fraine Ford, Community Impact Officer East, Surrey Fire and Rescue Service (SFRS)

Petitions, Public Questions, Statements: None

Member Discussion – key points:

- Discussion took place regarding the difficulty in finding a site for a new fire station in Burgh Heath. The Area Manager reported that SFRS were in discussion with Surrey County Council's Property Services, and that he hoped to have completed the move by August 2014. He assured Members that contingency plans were in place.
- Members wished to know if there were patterns to malicious calls. The Area Manager informed the Committee that malicious calls were recorded on spreadsheets in order that persistent offenders could be targeted.
- The Chairman noted that she was pleased to see the number of young people attending Safe Drive Stay Alive and the number of SEN pupils spoken to by the Fire Safety Team. She encouraged all Members to see a performance of Safe Drive Stay Alive.
- It was noted that East Surrey Hospital generated many Automatic Fire Alarm (AFA) calls, and Members wished to know how the service was responding to this. The Area Manager replied that since hospitals are considered high risk premises, SFRS has to attend. Ongoing work was taking place with East Surrey Hospital around this.

- The Vice-Chairman, speaking in her capacity as Cabinet Associate for Fire and Police Services, thanked SFRS for their work and ensuring that safety messages were reaching the community, particularly vulnerable people. She highlighted the fact that there had been no fatalities through fire in the borough in the past year.

Resolution:

The Local Committee **NOTED** the report.

[A revised Annex 1 was tabled and is attached to the minutes as **Appendix D.**]

55/13 DEMENTIA FRIENDLY SURREY CHAMPIONS - REIGATE AND BANSTEAD [NON-EXECUTIVE FUNCTION] [Item 11]

Declaration of Interest: None

Officer attending: Liz Tracey, Project Officer – Dementia Friendly Communities, Adult Social Care

Petitions, Public Questions and Statements: None

Member Discussion – key points:

- Members expressed their strong support for the initiative, and highlighted pieces of work that were already contributing to the agenda, such as SFRS and Adult Social Care’s joint work around vulnerable adults, and the Borough Council’s appointment of an Ageing Well Co-ordinator.
- Concerns were raised that East Surrey Clinical Commissioning Group (CCG) were not involved. The Project Officer clarified that whilst East Surrey CCG had not received Government funding from the Dementia Challenge, they were signed up to the initiative and were promoting it.
- Clarification was sought as to whether care homes were part of the initiative. The Project Officer confirmed that they were.
- A question was asked regarding the involvement of day services and carers of people with learning disabilities. The Project Officer responded that the needs of people with learning disabilities and dementia were key to the initiative, and work with Surrey and Borders Partnership Trust to fill in the gaps was taking place. Work was also taking place to raise awareness in day services.

Resolution:

The Committee **AGREED:**

- (i) To collectively become a Dementia Friendly Surrey Champion.
- (ii) To sign up to the Ageing Well Commitment and select one or more of the pledges set out in Annex 1 to the report submitted at a later date.

- (iii) To identify steps to action these pledges in order to nurture a dementia friendly borough.

[A presentation was tabled and is attached to the minutes as **Appendix E.**]

56/13 HIGHWAYS SCHEMES UPDATE REPORT [EXECUTIVE FUNCTION] [Item 12]

Declarations of Interest: None

Officers attending: John Lawlor, South East Area Team Manager and Anita Guy, Senior Engineer, Surrey Highways

Petition, Public Questions, Statements: None

Member Discussion – key points:

- The local Member for Banstead, Woodmansterne and Chipstead expressed a hope that further solutions to the issues in Croydon Lane would be explored.
- Members wished to know whether the road maintenance items brought forward, such as Philanthropic Road, Redhill, would take place this year. The Area Team Manager reported that this was on the Operation Horizon list, which would be circulated outside the meeting (*Post-meeting note: this has been actioned*).
- A question was asked regarding the progression of tree and verge works. The Area Team Manager agreed to investigate whether this was being carried out by the Community Gang or the Central Team.
- A request was made for updates on footways and the new gulley cleaning contract. The Area Team Manager agreed to seek an update from the Central Team regarding footways, and reported that gulley cleaning would take place in December and March.

Resolution:

The Committee:

- (i) **NOTED** the contents of Annex 1 to the report submitted; and
- (ii) **AGREED** that the proposal to provide a pedestrian refuge in Croydon Lane, Banstead is not progressed at the current time.

57/13 PROPOSED 20MPH ZONE FOR CHIPSTEAD [EXECUTIVE FUNCTION] [Item 13]

Declarations of Interest: None

Officer attending: Not applicable – report presented by Mr Ken Gulati, local Member for Banstead, Woodmansterne and Chipstead

Petitions, Public Questions, Statements: One statement received.

Member Discussion – key points:

- Concerns were raised that many roads in the borough were being used as “rat runs”, and whilst parts of Chipstead may require a 20mph limit, a blanket limit was unnecessary, particularly given that Chipstead did not have a school and the zone would not be enforceable by the police. It was also noted that Hazelwood Lane already had a restriction on lorries.
- Concern was also raised regarding a previous traffic calming scheme instigated by Chipstead Residents’ Association.
- Members sought clarification that no direct funding would be required for the proposal. The Highways Area Team Manager confirmed that the scheme was not on the forward programme for SCC funding at the moment.
- Some Members supported the proposal on the grounds that a blanket 20mph zone would prevent displacement of traffic, and that the community were fully supportive. It was also noted that 20mph zones were common in other parts of the country. Others felt that whilst it would be useful to have a large scale 20mph experiment in Surrey, it was difficult to approve the scheme in principle without knowing the costs.
- An amended recommendation was proposed by the Vice-Chairman, and seconded by Mr Nick Harrison and Dr Zully Grant-Duff. This was put to the vote and carried.

Resolution:

The Committee **AGREED** that:

- (i) Investigation by Chipstead Residents’ Association into a 20mph zone for Chipstead takes place, based on the area outlined in Annex 2 to the report submitted.
- (ii) A full report and recommendations be brought to a future meeting of the Local Committee following agreement of details with officers and Police.

**58/13 PROPOSED HIGHWAYS IMPROVEMENTS - LANGSHOTT, HORLEY
[EXECUTIVE FUNCTION] [Item 14]**

Declarations of Interest: None

Officer attending: Dave Taylor, Project Engineer, Economy, Transport and Planning

Petitions, Public Questions, Statements: None

Member Discussion – key points:

- The Chairman, also local Member for Horley East, thanked the Project Engineer and his team for the thoroughness of their work. She noted that the input of residents had been excellent, and that the Farmhouse pub had been helpful in enabling meetings to be held, often at short notice.

- The Vice-Chairman, also local Member for Horley West, Salfords and Sidlow, noted that this issue had been ongoing for many years, and that she had been involved with partners in obtaining funding for the Fastway scheme from central Government, resulting in a scheme which served all parts of the community. She was aware of residents' concerns, but understood that the road needed to be improved in order for the bus to safely access it.

Resolution:

The Committee **AGREED** that:

- (i) Authority is given to support the scheme to reconstruct Langshott and provide passing places and a footway to facilitate the bus service, subject to the identification of available funding, as set out in Option 3c.
- (ii) To authorise the advertisement and introduction of a Traffic Regulation Order to reduce the speed limit to 30mph.
- (iii) To authorise the advertisement and introduction of a Traffic Regulation Order for the prohibition and restriction of waiting, loading and unloading on Langshott, to avoid vehicles causing an obstruction to the bus route.
- (iv) To authorise the advertisement and introduction of a Traffic Regulation Order for the "Bus Only Access" from The Acres onto Langshott.
- (v) That the consideration and resolution of any representations received as a result of advertising the above Traffic Regulation Orders be delegated to the South East Surrey Area Team Manager in consultation with the Chairman and Vice-Chairman of the Local Committee and local elected Members.

**59/13 REDHILL BALANCED NETWORK - UPDATE [EXECUTIVE FUNCTION]
[Item 15]**

The Vice-Chairman took the chair for this item.

Declarations of Interest: None

Officers attending: Paul Fishwick, Local Sustainable Transport Fund (LSTF) Project Manager and Narendra Mistry, Principal Design Engineer, Environment and Infrastructure

Petitions, Public Questions, Statements: None

Member Discussion – key points:

- The local Member for Redhill West and Meadvale reported that Reigate and Banstead Borough Council was contributing £1.1 million to the project. She confirmed that she was happy with the proposals for Station Road East and that discussions regarding the accommodation of minicabs had been positive.

- The local Member for Redhill East expressed support for the proposals as they currently stood, but sought assurance that the proposed bollards would not break, and that cycle lanes crossing entrances and junctions would be marked. He also expressed concern that a new pinch point would be created near McDonalds at the crossing points at the bus station. The Project Manager agreed to look at best practice for rise and fall bollards. Signs and lining across junctions would be provided and the raised tables would assist with safety. He also agreed to look at the bus station crossing points.
- The Vice-Chairman thanked the task group for their input.

Resolution:

The Committee **AGREED:**

- (i) To the proposed flat top tables indicated in Annex B1 to the report submitted, and in Annex A plan numbers 101 and 111, and to authorise the advertisement of an appropriate Notice, and to note the treatments to the crossings in Annex B2 to the report submitted.
- (ii) Not to advertise the possible flat top road tables indicated in Annex B1 to the report submitted, and in Annex A plan numbers 102 and 104 at this time, due to the comments received from the bus operators, and to continue work with the bus operators to try and find an amicable solution.
- (iii) To the proposed segregated cycle/footway route located in Queensway as indicated in Annex A to the report submitted on plan 111.
- (iv) To the proposed location of Bus Stop Clearways at bus stops identified within the town centre as indicated in Annex A to the report submitted on plans 101, 102, 106, 108, 109, 110 and 111.
- (v) That if objections are received to the advertisement of the legal notices and traffic orders, the Area Team Manager is authorised to try and resolve them in consultation with the Chairman, Vice-Chairman, Divisional Member and Project Manager, and decide whether or not they should be acceded to and therefore whether the orders should be made, with or without modification.
- (vi) To the proposed options for the Station Road East public realm, as indicated in Annex C to the report submitted, and agreed that these options be the subject of a public consultation between 23 September and 3 November (6 weeks) and the feedback from the consultation is reviewed by the Member task group and the Local Committee.

60/13 LOCAL SUSTAINABLE TRANSPORT FUND - TRAVEL SMART PROGRAMME [FOR INFORMATION ONLY] [Item 16]

Declarations of Interest: None

Officer attending: Marc Woodall, Travel SMART Engagement Team Manager

Petitions, Public Questions, Statements: None

Member Discussion – key points:

- Members wished to know when the Travel SMART shop in the Belfry was due to open. The Engagement Manager reported that the lease had been signed and agreed and a manager was in place. Other partners would be participating too, and it was hoped that the shop would open in mid-October. An update would be provided to the LSTF Task Group at its next meeting on 24 September.
- Members asked whether it would be possible to hold a Cycling Festival in Redhill or Merstham in 2014. The Engagement Manager responded that the Cycling Festival was due to become an annual event, and Priory Park had been a fantastic venue. However, it may be possible to hold an additional event in Redhill or Merstham.

Resolution:

The Committee **NOTED**:

- (i) The LSTF Annual Report for 2012/13.
- (ii) Progress made to date on the Travel SMART programme.
- (iii) The forward plan for decisions as part of the Travel SMART programme.

61/13 CABINET FORWARD PLAN [AGENDA ITEM ONLY] [Item 17]

Resolution:

The Committee **NOTED** the report for information.

[The Local Divisional Member for Nork and Tattenhams reported that he had met with volunteers and staff at the Tattenhams Community Partnered Library and that this was working very well.

The Chairman agreed to write to the Cabinet Member for Schools and Learning expressing the Committee's support for new and expanded schools in the borough.]

62/13 LOCAL COMMITTEE FORWARD PLAN [AGENDA ITEM ONLY] [Item 18]

Resolution:

The Committee **NOTED** the report for information.

Meeting ended at: 4.46 pm

Chairman

SURREY COUNTY COUNCIL**LOCAL COMMITTEE (REIGATE & BANSTEAD)**

DATE: 16 SEPTEMBER 2013
SUBJECT: PUBLIC QUESTIONS AND STATEMENTS
DIVISION: ALL REIGATE & BANSTEAD DIVISIONS

**1. Consultation on Planning Applications – Prof Garth Swanson**

“When the borough council receives a planning application, it asks the County Highways department for comment. The response is made on a form with a number of check boxes and the opportunity to state if the site was visited. Having looked at a number of applications with which I have close acquaintance, I find that the responses are often made very casually without even visiting the site.

A close examination of the case would certainly have brought forward a completely different response from the County. Is the Local Committee satisfied that the Highways department is acting diligently in this respect?”

The Chairman responds on behalf of the Local Committee:

“Every single application published on the Reigate and Banstead weekly list of planning applications is looked at by an officer from Transport Development Planning (TDP).

TDP will consider whether the application will have an impact on road safety as the primary concern, but in addition, concerns relating to traffic congestion, and wider transportation policy issues are included in our assessment. These wider considerations include the need to reduce reliance on the private car, and issues relating to parking, changes to access, pedestrian and cycle access/parking, rights of way and travel planning to name a few. This happens initially as a desk top assessment - looking at the application documents submitted and using local knowledge to make a decision on whether or not there is likely to be any impact on the public highway.

If the decision is made that there is unlikely to be any impact on the public highway, the form referred to below is filled in and submitted to Reigate and Banstead Borough Council without a site visit being made. Officers have assured me that the response is therefore not made casually but only after careful consideration as described above. Officers also state that they err on the side of caution with these assessments and will always choose to make a site visit even if they are unsure about whether there will be an impact.

On applications where officers consider there is likely to be an impact that needs further consideration and a site visit, they do not fill in the form referred to in the question, but complete what is known as a CR1 document - making recommendations either for approval with conditions or refusal - depending on their assessment.

MINUTES - APPENDIX A

It is also worth noting that, in Reigate and Banstead alone, TDP are consulted on approximately 2,000 applications a year, and therefore in terms of resource officers have to use their knowledge and experience to make desk top assessments as it is not possible to make site visits for the more minor applications where the impact is likely to be insignificant or negligible.”

Contact Officer:

Martin Gilmour, Senior Transport Development Planning Officer, 020 8541 7423

2. Proposed 20mph Zone for Chipstead (relates to Agenda Item 13) – Mr Vic Parks

“I am opposed to the Chipstead Residents Association proposal to introduce 20mph zones on the following grounds:

There is a real danger that the anti-motorist lobby will end up treating humans like robots. For example, automatic speed limiters would prevent drivers from making reasonable driving judgements. Thus – controlled by a computer.

Safety is the “unsinkable argument” often used by “anti” pressure groups. The anti-motorist lobby uses this excuse (Chipstead RA in this case), even though surveys show that Britain is one of the safest places to drive with the safest drivers in the world. Whatever measures are used to make roads 100% safe (accident free), it is an impossible dream. “Making us safe” over the past few decades has been at the cost of more and more unreasonably restrictions, bizarre safety measures and the making of huge in-roads into our civil liberties.

Although a motorist, I occasionally ride a bike. A few motorists do need educating to take care when near cyclists. 20mph zones will not deter these motorists who put cyclists at risk. I believe few motorists deeply resent cyclists and, sometimes, deliberately put them at risk. Apart from the increase in road rage 20mph zones are likely to cause, pollution will increase in low gears. From recent research into 20mph zones, accidents will go up, which contradicts the safety argument! Vehicle wear will also increase substantially. At peak times it is rare to get above 20mph and for off-peak times, 20mph 24/7 is unreasonable.

I wonder whether the influential lobby behind the proposal is the horse-riding fraternity. For example, the report states that “...the lanes were originally intended for horses.” It adds: “[Cyclists and horse riders]...provide a compelling reason for the adoption of the 20mph zone.” I suppose these take precedence over the thousands of people using the local road networks to travel to work, business, domestic, social and pleasure, etc?

According to their report, they considered privatising the roads so that they could “...bring about road closures.” Going down this somewhat selfish road could lead to dividing our national road networks into toll gated roads to be used by a privileged few. Currently, we all own the public road network and pay for it through motor taxes, amongst other means.

Although I sympathise with the Chipstead residents wishing to keep a rural feel about the village, it is a reality that the Greater London sprawl and technological developments, over decades, have finally caught up with them. Chipstead Residents' Association needs to be very careful about what it wishes for. If passed, this proposal would be a precedent and a "thin end of the wedge". Before long, this could spread around other parts of the borough, surrounding areas and nationally like a plague. In Brighton and Hove, for example, the attack on motorists over recent years has reached a crescendo by the council's proposal to make most roads 20mph. This has caused considerable public anger. It is clear that the public do not want them!"

Verbal response to be provided during the discussion on Agenda Item 13.

3. Reigate and Banstead Parking Review Ratification of Proposal of Consultation re. Parking Restrictions – Manor Road, Reigate (Agenda Item 9) – Mrs Jane Straker

"I represent the undersigned members of the community and co-authors of this statement, interested in safety for all road users in the area of Manor Road. Unfortunately several of these persons are unable to attend due to work, family and holiday commitments.

We all supported the original proposal for all day parking restrictions in Manor Road, believing that it addressed our concerns for the safety of all users of Manor Road during the working day. However, we feel that the revised proposal and recommendation is inadequate and will only address our concerns for a small part of the day, and that after 11am, there will be a build up of parking and the current problems will remain for the balance of the day.

We do appreciate that the road is a public resource, and that demands for parking facilities are ever increasing, but feel that this should not be at the expense of safety to road users and residents, which is our sole concern.

Under the consultation, it was proposed that a "No waiting restriction, Monday to Saturday, 08.00 to 18.30 hours" on the south side of Manor Road from the proposed extended double yellow lines on the south side of the road, to the boundary between numbers 5 and 7 be implemented. The recommendation before the committee today is to "Introduce a revised proposal on Manor Road, 'no waiting Monday-Friday, 10am-11am'".

Manor Road, between Somers Road and the boundary of numbers five and nine is made up of two reciprocal bends. Motorists regularly park on both sides of the road and pavement. This compromises the safety of all road users in the immediate area of Manor Road, Pilgrims' Way, Nutley Lane and Somers Road, due to the visibility lines of Manor Road through the bends being totally obscured by parked cars. Negotiating the crossroads of these four roads is extremely dangerous due to lack of visibility. In addition, the need for access from driveways onto the road is disregarded by parking motorists, who often park inconsiderately on or beyond the edges of driveways. Residents endeavouring to exit their driveways have to do so blindly as it is impossible to see whether any vehicles are approaching. Again, this has proved to be an extremely dangerous manoeuvre (these situations are demonstrated by the accompanying photographic evidence).

MINUTES - APPENDIX A

Despite the recommendations before the committee, the residents remain extremely concerned about the safety of all persons using this area during the time parking will be permitted on the south side of the road.

We would obviously prefer the original proposal, but at the very least, would ask the committee to consider extending by one hour the hours of the restriction of parking indicated in the recommendation, and would suggest an additional one hour period of restricted parking, say between 2pm and 3pm. This would exercise some control over both the morning and the afternoon sessions of long-term parking motorists, but still permit Micklefield parents to park when collecting their children at 3.15pm.

However, the priority is to try and deal with the matter of safety for all road users, and regardless of which scheme is adopted, we feel strongly that there should be a review of the situation within three to six months, to ensure that these road proposals satisfy the objective. If the dangerous situation remains, even for part of the day, we, the residents, will press for further action."

The Chairman responds on behalf of the Local Committee:

"Manor Road and the surrounding roads in this area are used for parking by residents, rail commuters, school parents, local workers and other visitors. Parking space is generally at a premium in this part of Reigate and reducing it will generally have a knock on effect and can cause displacement elsewhere.

The advertised proposal in this location, to introduce a single yellow line waiting restriction with operational times between 08.00 and 18.30 Monday to Saturday, was requested and proposed to reduce obstructive parking and help improve access for residents on this length.

The statutory consultation process resulted in 12 objections from school parents and nearby residents (including a 233 signature petition) highlighting concerns about this proposal. These were that the planned restriction would reduce parking for the nearby school at pick up and drop off times and that other nearby residents and their visitors would have less space to park as a result of displacement.

The modified proposal is to have a restriction between 10.00 and 11.00am, Monday to Friday. This will prevent all day commuter parking on this stretch of road whilst still allowing school parents to park for the school run for short periods each day and other residents to use the road outside the restriction times.

Whilst we recognise the concerns raised in Mrs Straker's question about some residents difficulties using their driveways on occasion, this problem is not uncommon in towns and villages across the UK. Obstruction of a drop kerb access on to the highway is an offence and can be reported to Surrey police or the Reigate and Banstead parking team for enforcement action. The revised proposal being put to the Committee for approval is a compromise to try to meet the needs of all concerned and should improve the current situation."

Contact Officer:

David Curl, Parking Team Manager, 03456 009 009

SURREY COUNTY COUNCIL

LOCAL COMMITTEE (REIGATE & BANSTEAD)

DATE: 16 SEPTEMBER 2013

SUBJECT: MEMBER QUESTIONS AND STATEMENTS

DIVISION: EARLSWOOD & REIGATE SOUTH



1. Kings Mill Lane – Ms Barbara Thomson (Earlswood and Reigate South)

“What safety measures are Surrey going to implement on Kings Mill Lane after the recent spate of very nasty accidents on the bend?”

The Chairman responds on behalf of the Local Committee:

“The Area Highways Team Manager has asked that warning signs are placed as soon as possible to indicate to Vehicle Operators that the road is potentially slippery. The Area Manager has also requested further testing of the surfacing condition in this area to allow engineers to come up with an informed solution to improve safety on this length of carriageway.”

Contact Officer:

John Lawlor, Area Team Manager, South East Area Team, 03456 009 009

This page is intentionally left blank

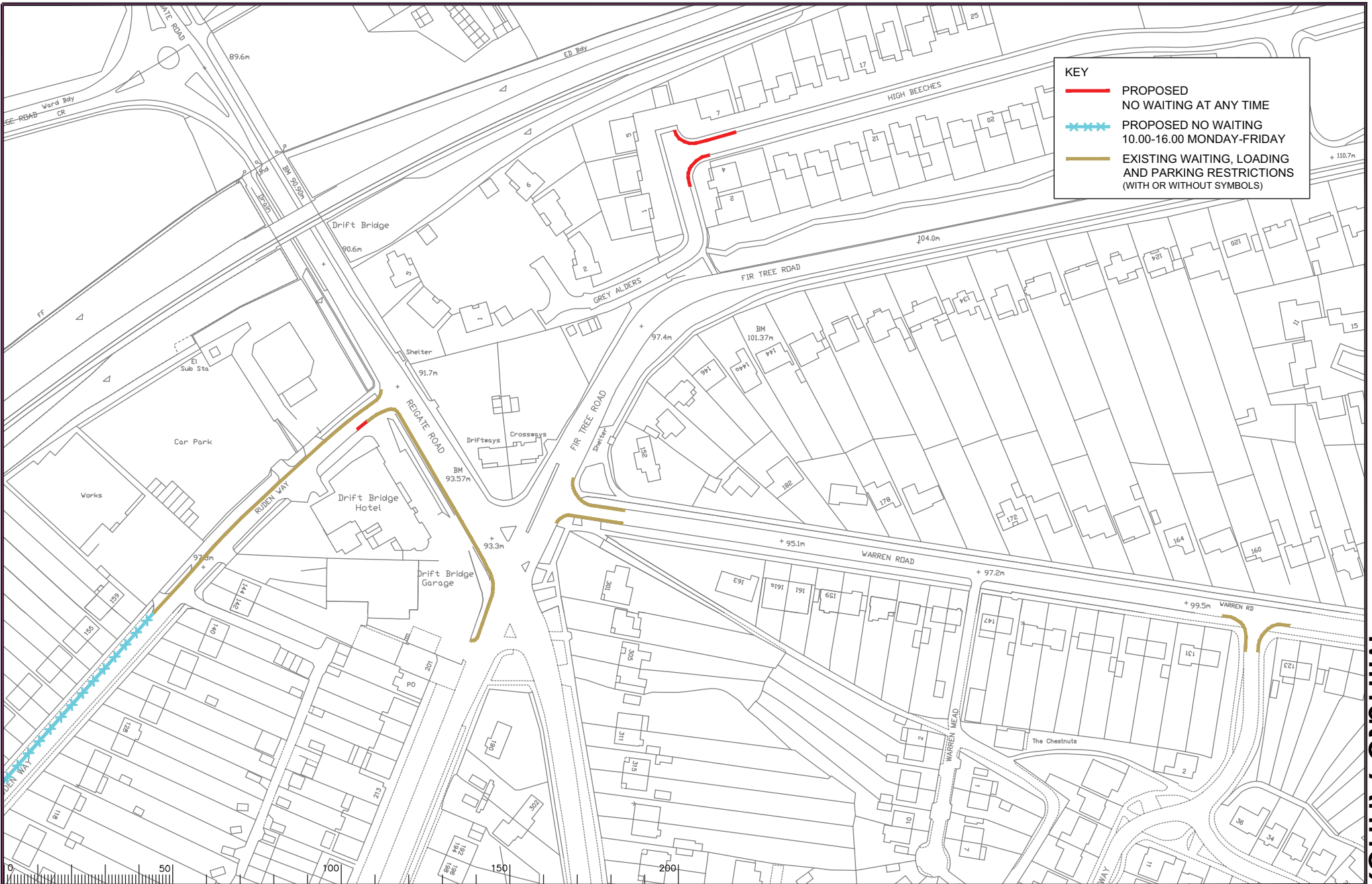

KEY

- PROPOSED NO WAITING AT ANY TIME
- - - - PROPOSED NO WAITING 10.00-16.00 MONDAY-FRIDAY
- EXISTING WAITING, LOADING AND PARKING RESTRICTIONS (WITH OR WITHOUT SYMBOLS)

Notes

Rev.	Description	Drwn	Sig.	Date	Chkd	Sig.	Date	Appr	Sig.	Date

Rev.	Description	Drwn	Sig.	Date	Chkd	Sig.	Date	Appr	Sig.	Date

North Point

Based upon the Ordnance Survey mapping with the permission of the Controller of Her Majesty's Stationary Office. © Crown copyright. Unauthorised reproduction infringes Crown copyright and may lead to prosecution or civil proceedings. Surrey County Council LA 278822 1800.

Drawn by: CAH, Date: 2012
 Checked by: RH, Date: 2012
 Approved by: DC, Date: 2012

Project: REIGATE AND BANSTEAD DPE BANSTEAD

Drawing: IMPLEMENTED TRAFFIC ORDERS

Project No: 3282/R&B
 Contract Sheet No: 18001
 Rev: -
 Classification: PROPOSED

SURREY COUNTY COUNCIL

Project No: 3282/R&B
 Contract Sheet No: 18001
 Rev: -
 Classification: PROPOSED

SHEET OF

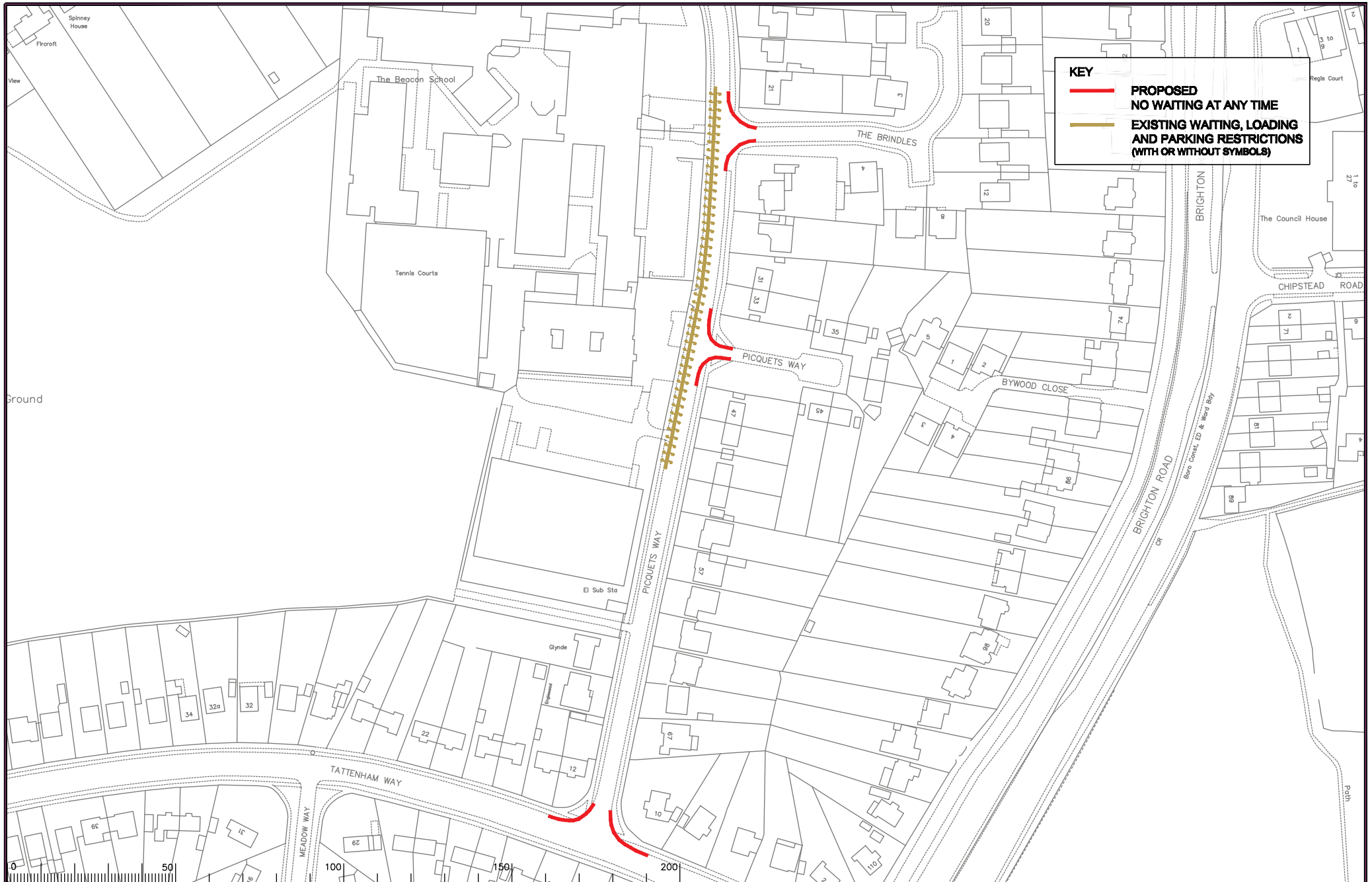

KEY

— PROPOSED
NO WAITING AT ANY TIME

- - - EXISTING WAITING, LOADING
AND PARKING RESTRICTIONS
(WITH OR WITHOUT SYMBOLS)

Notes

Rev.	Description	Drwn	Sig.	Date	Chkd	Sig.	Date	Appr.	Sig.	Date

North Point

Drawn by: CAH, Date: 2/12
 Checked by: RH, Date: 2/12
 Approved by: DC, Date: 2/12

Project: REIGATE AND BANSTEAD DPE
BANSTEAD
IMPLEMENTED TRAFFIC ORDERS

Project No: 3282/R&B
 District: -
 Sheet No: 18012
 Drawing No: -
 Date: -
 Description: PROPOSED

SHEET OF

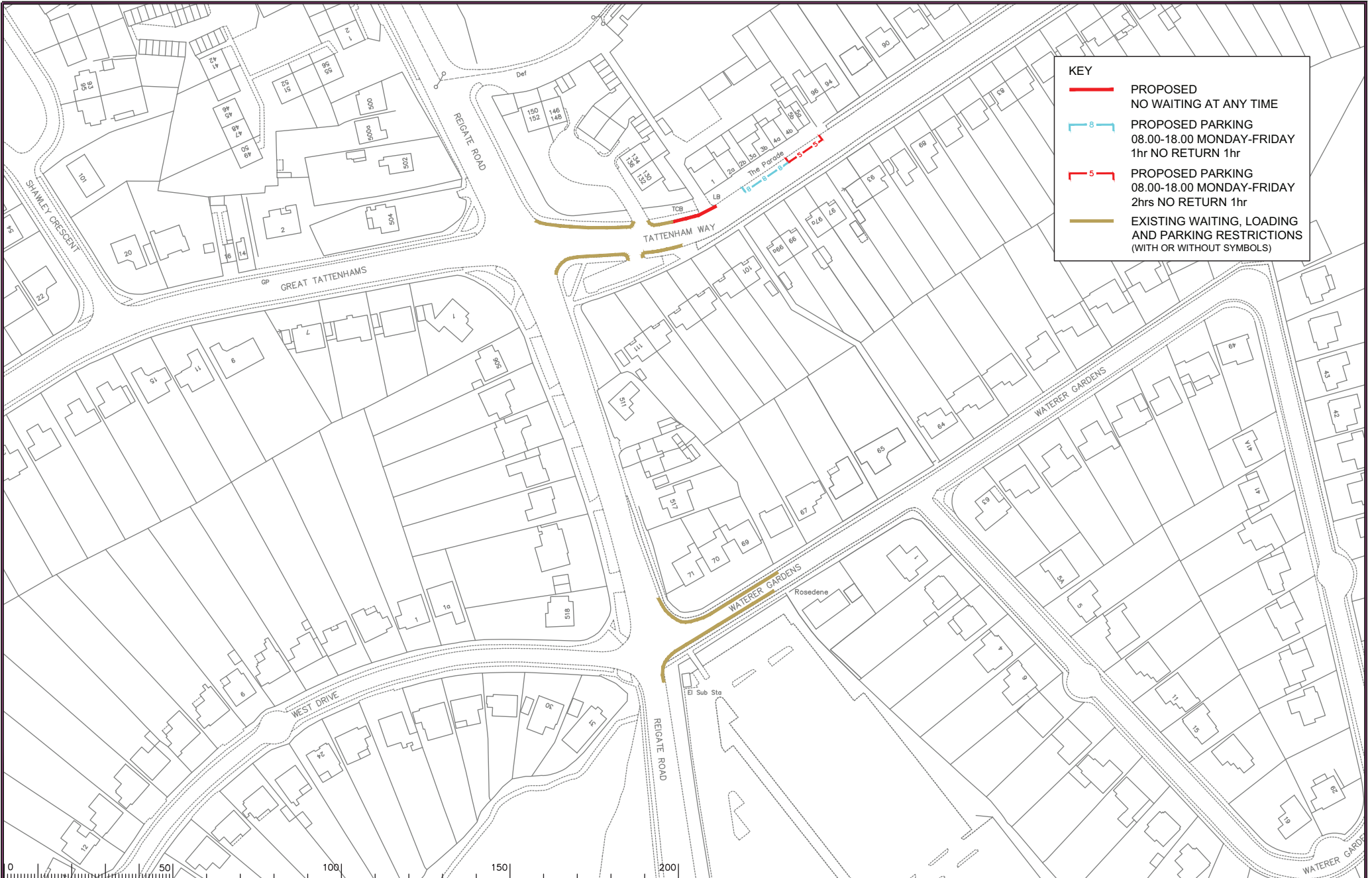

KEY

- PROPOSED
NO WAITING AT ANY TIME
- 5 PROPOSED PARKING
08.00-18.00 MONDAY-FRIDAY
1hr NO RETURN 1hr
- 5 PROPOSED PARKING
08.00-18.00 MONDAY-FRIDAY
2hrs NO RETURN 1hr
- EXISTING WAITING, LOADING
AND PARKING RESTRICTIONS
(WITH OR WITHOUT SYMBOLS)

Rev.	Description	Dwn	Sig.	Date	Chkd	Sig.	Date	Appr	Sig.	Date

North Point

Based upon the Ordnance Survey mapping with the permission of the Controller of Her Majesty's Stationary Office. © Crown copyright. Unauthorised reproduction infringes Crown copyright and may lead to prosecution or civil proceedings. Surrey County Council LA 20822 1205.

Drawn by	CAH	Sig.	CAH	Date	2012
Checked by	RH	Sig.	RH	Date	2012
Approved by	DC	Sig.	DC	Date	2012

**REIGATE AND BANSTEAD DPE
TATTENHAM**

IMPLEMENTED TRAFFIC ORDERS

	Project No.	3282/R&B
	Contract No.	18022
	Rev.	-
SURREY COUNTY COUNCIL		Classification
SHEET OF		PROPOSED

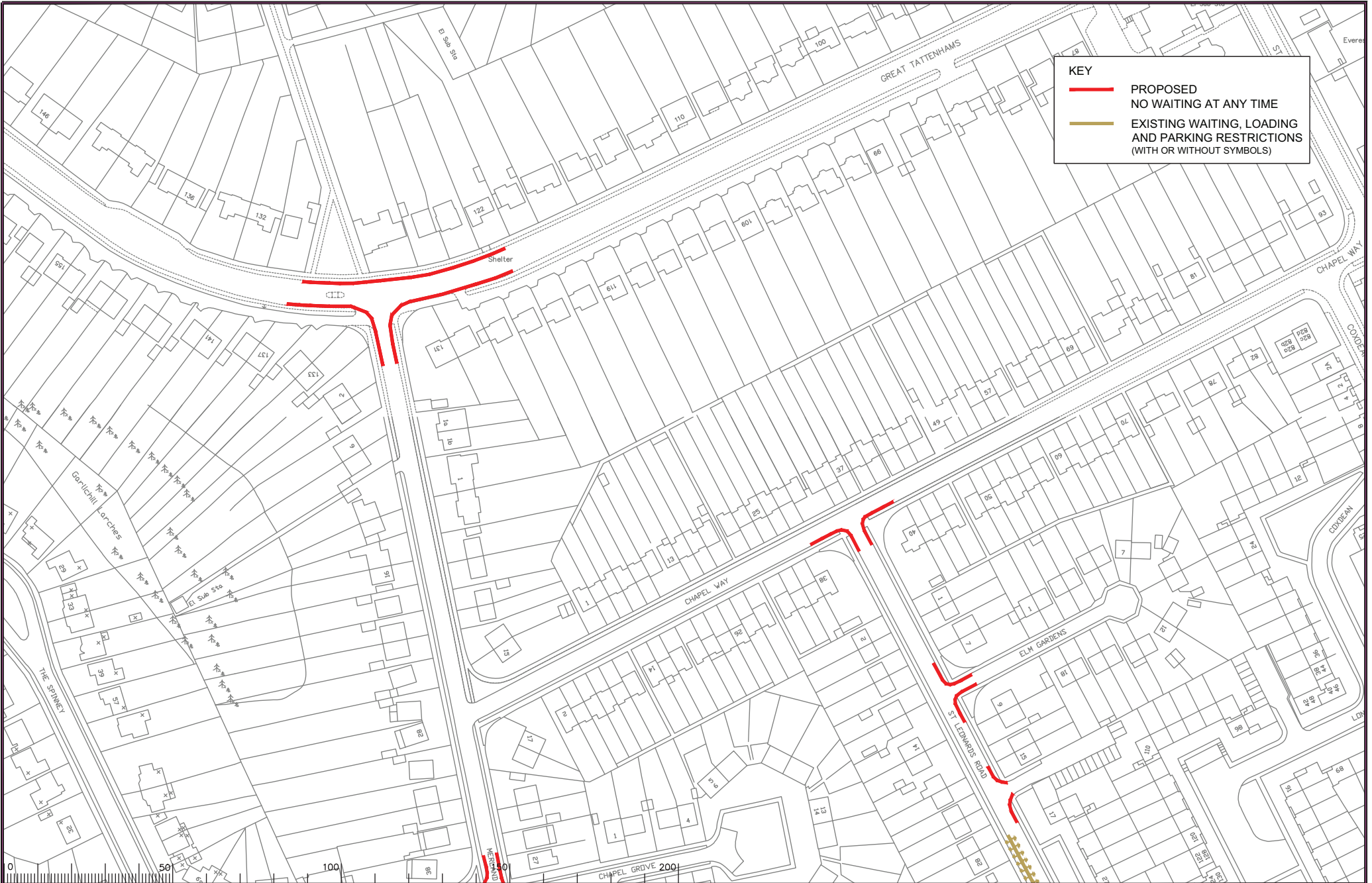

KEY

- PROPOSED NO WAITING AT ANY TIME
- EXISTING WAITING, LOADING AND PARKING RESTRICTIONS (WITH OR WITHOUT SYMBOLS)

Notes

Rev.	Description	Drwn	Sig.	Date	Chkd	Sig.	Date	Appr	Sig.	Date

Rev.	Description	Drwn	Sig.	Date	Chkd	Sig.	Date	Appr	Sig.	Date

North Point

Based upon the Ordnance Survey mapping with the permission of the Controller of Her Majesty's Stationary Office. © Crown copyright. Unauthorised reproduction infringes Crown copyright and may lead to prosecution or civil proceedings. Surrey County Council, LA 076872, 1999.

Drawn by	Sig.	Date
CAH	CAH	2012
Checked by	Sig.	Date
RH	RH	2012
Approved by	Sig.	Date
DC	DC	2012

Project
REIGATE AND BANSTEAD DPE TATTENHAM
 Drawing No. 18025
 Date 2012

Project No. 3282/R&B
 Contract Sheet No. 18025
 Drawing No. 18025
 Rev. -
 Classification PROPOSED

SURREY COUNTY COUNCIL

SHEET OF

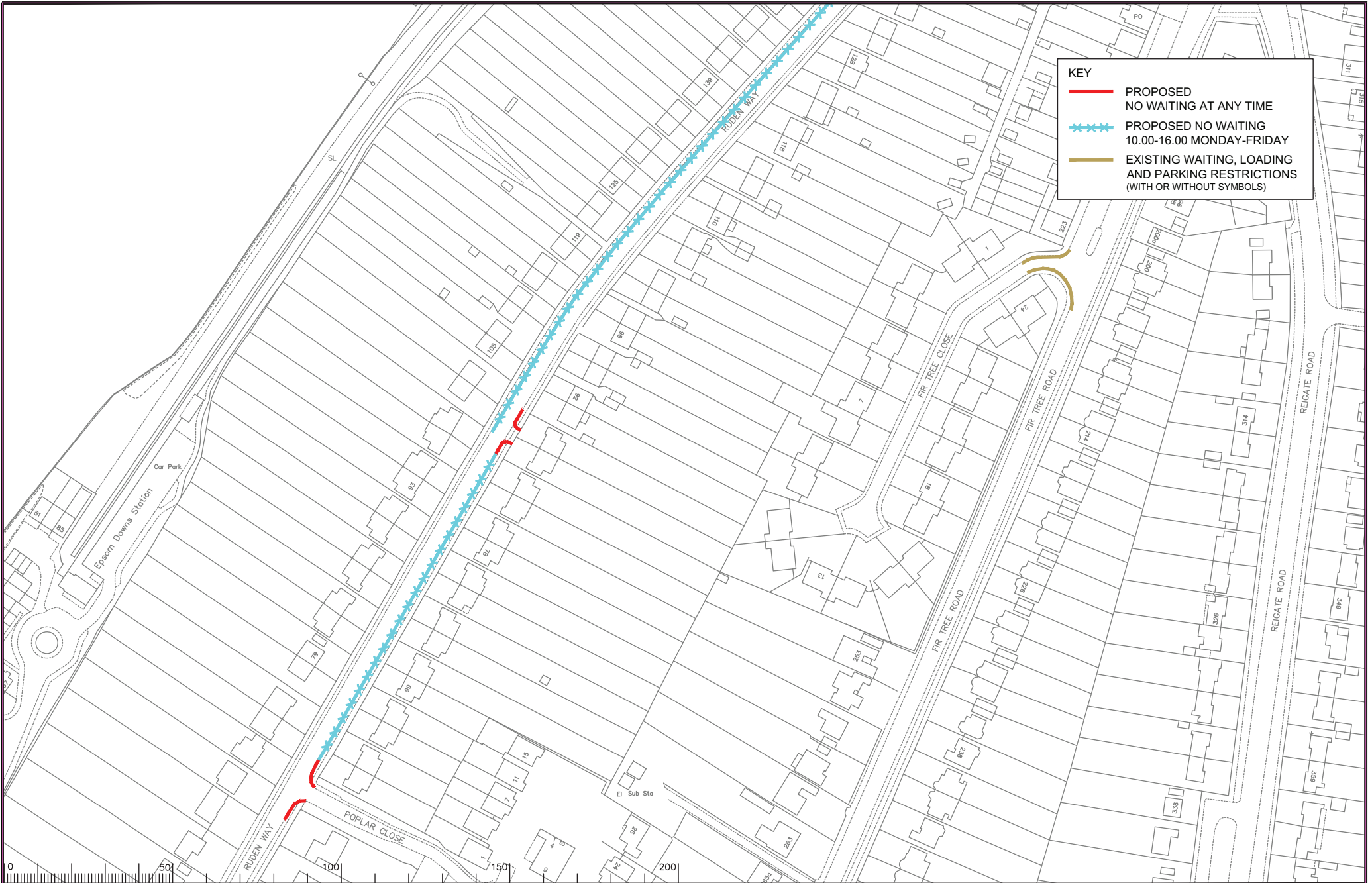

KEY

- PROPOSED NO WAITING AT ANY TIME
- - - * PROPOSED NO WAITING 10.00-16.00 MONDAY-FRIDAY
- EXISTING WAITING, LOADING AND PARKING RESTRICTIONS (WITH OR WITHOUT SYMBOLS)

Notes

Rev.	Description	Drwn	Sig.	Date	Chkd	Sig.	Date	Appr	Sig.	Date

North Point

Based upon the Ordnance Survey mapping with the permission of the Controller of Her Majesty's Stationary Office. © Crown copyright. Unauthorised reproduction infringes Crown copyright and may lead to prosecution or civil proceedings. Surrey County Council LA 278822 1800.

Drawn by: CAH, Date: 2012
 Checked by: RH, Date: 2012
 Approved by: DC, Date: 2012

Project: REIGATE AND BANSTEAD DPE BANSTEAD

Drawing: IMPLEMENTED TRAFFIC ORDERS

Project No. 3282/R&B
 Contract Sheet No. 18156
 Drawing No. -
 Rev. -
 Classification PROPOSED

SHEET OF

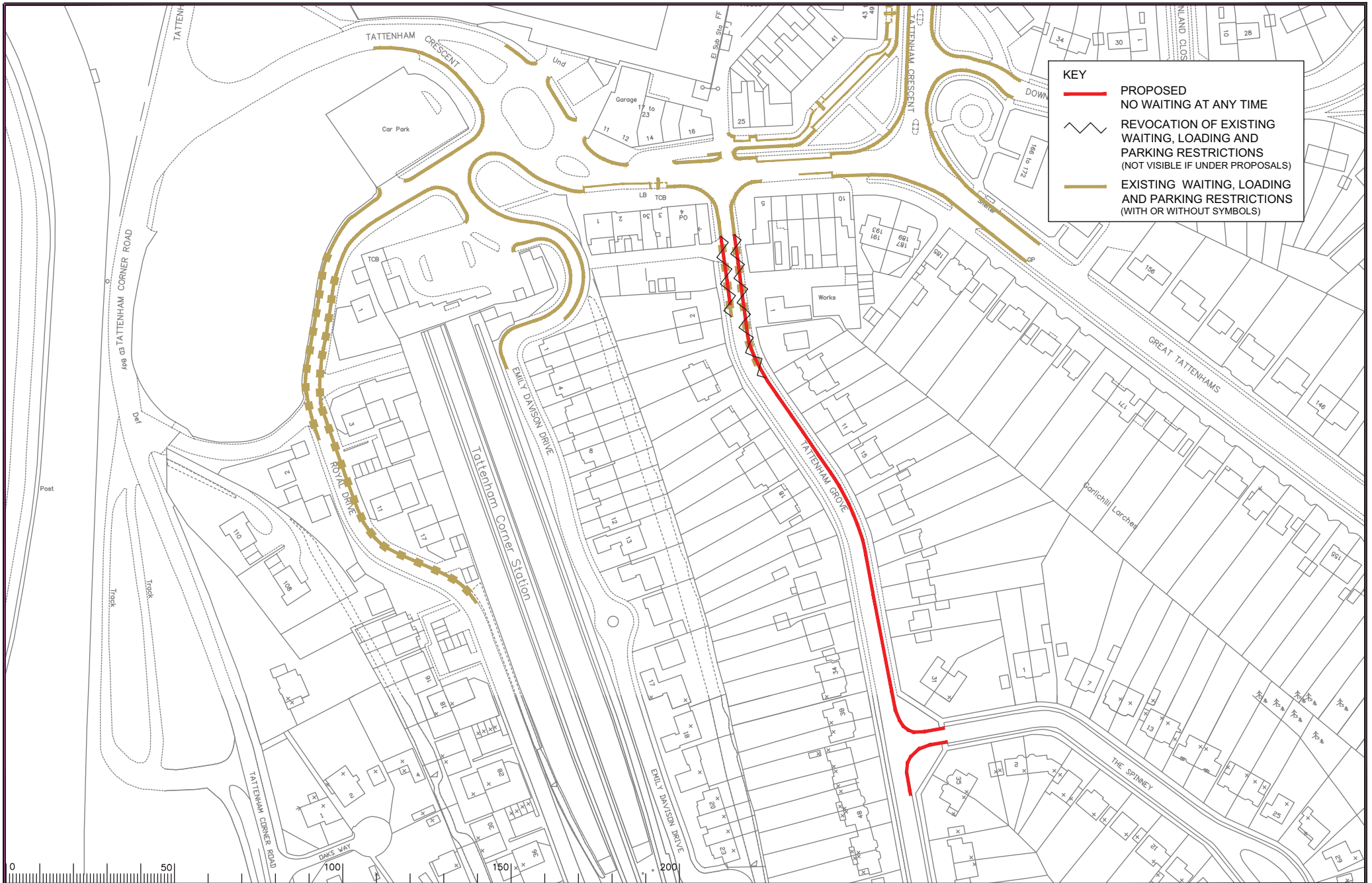

KEY

- PROPOSED NO WAITING AT ANY TIME
- - - REVOCATION OF EXISTING WAITING, LOADING AND PARKING RESTRICTIONS (NOT VISIBLE IF UNDER PROPOSALS)
- EXISTING WAITING, LOADING AND PARKING RESTRICTIONS (WITH OR WITHOUT SYMBOLS)



Rev.	Description	Drwn	Sig.	Date	Chkd	Sig.	Date	Appr	Sig.	Date

Drawn by	CAH	Sig.	CAH	Date	2012
Checked by	RH	Sig.	RH	Date	2012
Approved by	DC	Sig.	DC	Date	2012



**REIGATE AND BANSTEAD DPE
TATTENHAM**

IMPLEMENTED TRAFFIC ORDERS

Project No. 3282/R&B
Contract Sheet No. 18159
Drawing No. 18159
Rev. -
Classification PROPOSED

SURREY COUNTY COUNCIL

SHEET OF

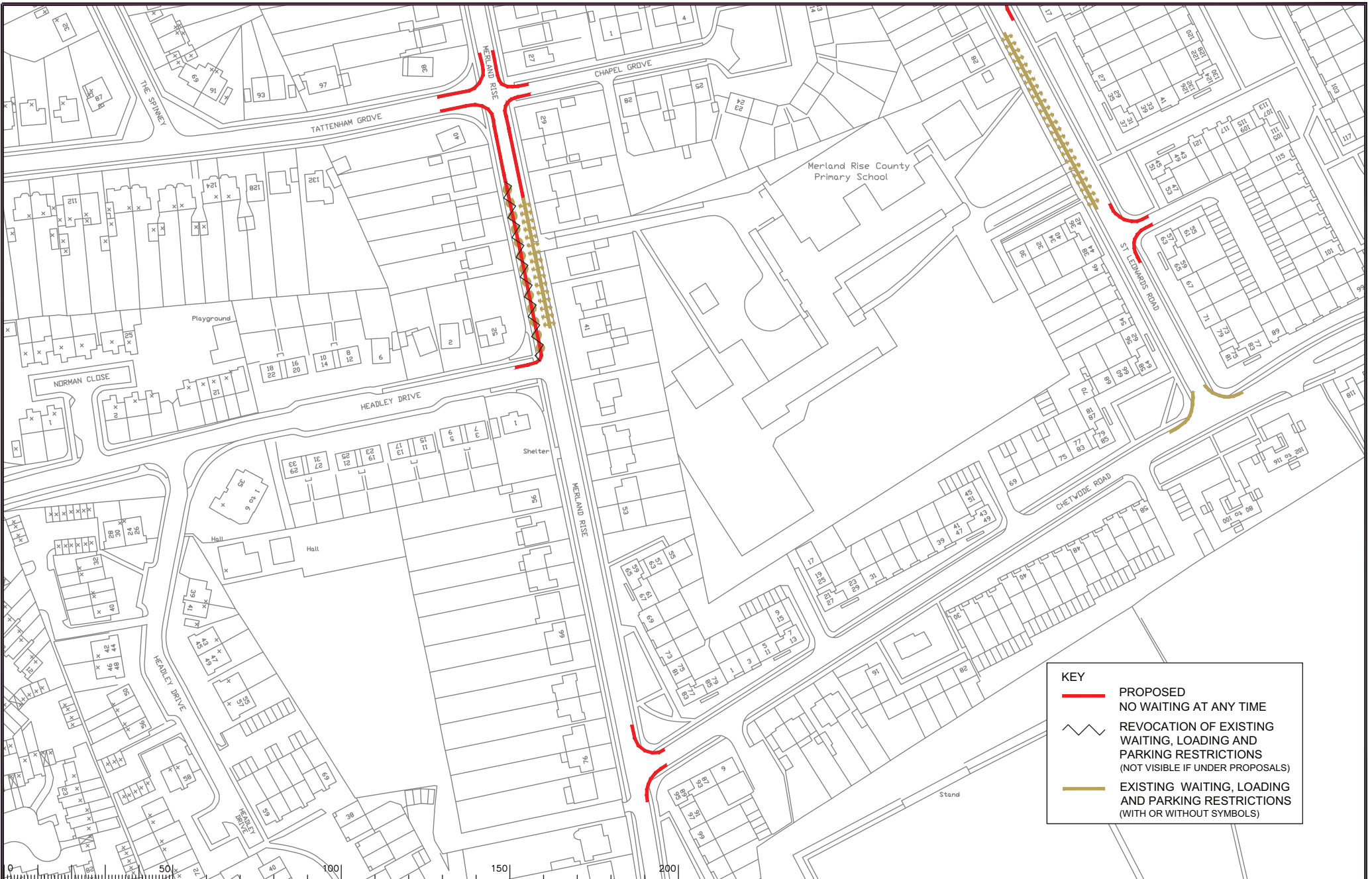

KEY

- PROPOSED NO WAITING AT ANY TIME
- REVOCATION OF EXISTING WAITING, LOADING AND PARKING RESTRICTIONS (NOT VISIBLE IF UNDER PROPOSALS)
- EXISTING WAITING, LOADING AND PARKING RESTRICTIONS (WITH OR WITHOUT SYMBOLS)

Notes

Rev.	Description	Drawn	Sig.	Date	Chkd	Sig.	Date	Appr.	Sig.	Date



Based upon the Ordnance Survey mapping with the permission of the Controller of Her Majesty's Stationery Office. © Crown copyright. Unauthorised reproduction infringes Crown copyright and may lead to prosecution or civil proceedings.
Surrey County Council LA 27627 1800.

Drawn by: CAH
Checked by originator: RH
Approved by: DC

Sig.
Sig.
Sig.

CAH
RH
DC

Date
Date
Date

2012
2012
2012

Project
Drawing

REIGATE AND BANSTEAD DPE
TATTENHAM
IMPLEMENTED TRAFFIC ORDERS



Project No. 3282/R&B
Contract Sheet No. 18160
Drawing No. 18160
Rev. -
Classification PROPOSED

SHEET OF

This page is intentionally left blank



MISSION

To provide a professional and well supported Fire and Rescue Service which reduces community risk in order to save lives, relieve suffering, protect property and the environment

*Surrey Fire and Rescue
Local Committee Report*

April 2012 – March 2013

Completed by

Station Manager Stuart de-Fraine Ford

Community Impact Officer East Area

Reigate & Banstead Borough

Contents

1	1
2	KEY ISSUE	3
3	SUMMARY	3
4	OFFICER RECOMMENDATIONS.....	3
5	REIGATE & BANSTEAD STATISTICS.....	4
6	REPORTING AGAINST IDENTIFIED TARGETS.....	5
7	FIRE SAFETY PROTECTION ACTIVITIES	7
8	COMMUNITY FIRE PREVENTION.....	8
9	SAFEGUARDING REFERRALS	8
10	VOLUNTEERS SERVICE	8
12	COMMUNITY ENGAGEMENT	9
13	WHAT HAPPENS NEXT	10

KEY ISSUE

- 1.1 This report outlines the major strands of activity being undertaken within The Reigate & Banstead area by the Surrey Fire and Rescue Service (SFRS) teams based at Reigate & Horley Fire Stations.

SUMMARY

- 1.2 The report contains information on the various activities undertaken by the Borough team to reduce the risk from fire, water and road traffic incidents to the residents of the Reigate & Banstead Borough, including direct contact, public education programmes and campaigns.

OFFICER RECOMMENDATIONS

The Local Committee is asked to:

- 1.3 Recognise the achievements of the borough teams within the Reigate & Banstead Borough and support their commitment to improve initiatives to reduce risk and make the Reigate & Banstead Borough safer through the delivery of the borough/station plan.
- 1.4 Note the targets and initiatives set within the Reigate & Banstead borough plan for 2012/13 and support the Fire and Rescue Service in the delivery of this plan.

REIGATE & BANSTEAD STATISTICS

Within Service/Borough Target		
Close to Service/Borough Target		
Above Service/Borough Target - Action Required		
Key Performance Indicators for 2012/13	2012/2013	2011/2012
Percentage of Fires attended in dwellings with no smoke detection fitted	Service Target < 38%	Service Target < 38%
	21%	29%
No of fatalities due to primary fires	Service Target 7	Service Target 7
	0	0
No of injuries arising from accidental dwelling fires	Borough Target 6	Borough Target 6
	18 (4)	2
No of false alarms caused by AFA's (automatic fire alarms)	Borough Target 225	Borough Target 225
	289	242
No of calls to malicious false alarms attended	Borough Target 19	Borough Target 9
	18	18
No of deliberate Primary & Secondary Fires (excluding vehicles)	Borough Target 121	Borough Target 121
	81	133
No of deliberate & Secondary vehicle fires	Borough Target 24	Borough Target 24
	19	13
No of calls to fires attended - primary	Borough Target 198	Borough Target 271
	224	216
No of calls to fires attended - Accidental fires in dwellings	Borough Target 77	Borough Target 77
	87	81
Percentage of accidental dwelling fires confined to room of origin	Borough Target >91%	Borough Target >91%
	91%	94%
No of fires in non domestic premises	Borough Target 40	Borough Target 40
	49	51
No of HFSVs (Home Fire Safety Visits) Visits to Risk Households	Service Target % at Risk >60%	Service Target % at Risk >60%
	266 (79%)	N/A

Total Visits	335	N/A
--------------	-----	-----

REPORTING AGAINST TARGETS NOT ACHIEVED

1.5 Injuries arising from accidental fires

2012/2013	2011/2012
Borough Target 6	Borough Target 6
18 (4)	2

- 1.6 None of the injuries arising from accidental fires have deemed to be serious, of the incidents reported all injuries have been precautionary check ups where casualties have either been removed to hospital or received medical intervention at scene due to effects of suffering smoke inhalation or minor burns.

1.7 Number of False Alarms caused by A.F.A'S (automatic false alarms)

2012/2013	2011/2012
Borough Target 225	Borough Target 225
289	242

- 1.8 Although Reigate and Banstead has a high level of AFA's in the Reigate and Banstead area, most of the repeat offenders are down to premises such as East Surrey hospital. This does not mean that we are not doing anything about this. Our protection teams are working closely with Staff and teams at East Surrey hospital to see if improving procedures in relation to AFA's can reduce the amount of calls that require a fire service appliance from attending.

1.9 No of calls to fires attended -primary

2012/2013	2011/2012
Borough Target 198	Borough Target 271
224	216

Although this year has seen an increase in the number of calls there is no evidence to show an increase in severity of primary fires attended in Reigate and Banstead.

1.10 No of calls to fires attended –Accidental fires in dwellings

2012/2013	2011/2012
Borough Target 77	Borough Target 77
87	81

1.11 Although this year has seen an increase in the number of calls there is no evidence to show an increase in severity of fires in dwellings. There is evidence to show that there has been an increase in the amount of fires in dwellings which have been confined to room of origin. Reigate and Banstead is one of six boroughs within Surrey to see an increase in calls to accidental fires in dwellings.

1.12 No of fires in non domestic premises

2012/2013	2011/2012
Borough Target 40	Borough Target 40
49	51

1.13 Although this year has seen an increase in the number of calls there is no evidence to show an increase in severity of fires in non domestic premises. Reigate and Banstead is one of four boroughs within Surrey to see an increase in calls to accidental fires in non-domestic premises.

COMMUNITY FIRE PROTECTION

1.14

Figures for 2012	
Prosecutions	0
Prohibition Notice - Formal	0
Enforcement Notice - Formal	1
Deficiencies Notice - Informal	28
Licensing Consultations	118 (East area total)
Building Regulation Consultations	735 (East area total)

Reigate & Banstead protection officers carry out statutory enforcement of fire safety legislation and provide the consultation on building regulations, licensing and complex designs for the Borough. They promote the professional and legal face of the Service that interacts with business and partner agencies.

Reigate & Banstead protection officers are responsible for inspecting and preparing reports for all premises subject to statutory control within Reigate & Banstead on behalf of the Fire & Rescue Service. They enforce Fire safety legislation through risk based assessment, whilst working in conjunction with other relevant partners and professional bodies to reduce the risk of fire and associated loss of life and property through enforcement of the RRFSO. (Regulatory Reform Fire Safety Order

COMMUNITY FIRE PREVENTION

1.15 We will undertake intelligence-based Home Fire Safety Visits (HFSV), in the areas most in need of this service, using the provided data and local knowledge to target this work. Currently a target of 60% is expected for our crews to reach vulnerable people and the most at risk from fire in our communities. SFRS will work closely with Adult and Social Care teams to ensure the following are targeted.

- Adults over the age of 65 (Worse at 75)
- Individuals who live alone
- Individuals with Mental Health illnesses, including Dementia & Memory Loss
- Individuals with disability and mobility difficulties
- Individuals who are either Alcohol or Drug dependant
- Individuals who smoke (The above will be compounded if coupled with smoking)

1.16

2012/2013	2011/2012
Service Target % at Risk >60%	Service Target % at Risk >60%
335	N/A
266(79%)	N/A

SAFEGUARDING REFERRALS

1.17 The Service works in collaboration with Social Services to ensure vulnerable adults/children are identified and care action plan is formulated.

2012/2013	2011/2012
Totals	Totals
30	N/A

VOLUNTEERS SERVICE

1.18 Our Volunteers assist firefighters in prevention and education activities. The volunteers work alongside the firefighters delivering crucial safety information to the general public at a wide variety of events, from Open Days to Public Events, and also delivering Home Fire Safety visits to the general public. Our volunteering scheme has proved to be highly successful and we have a high number of volunteers out in the community assisting our firefighters in delivering safety information, as a result we have managed to reach more households and importantly, more vulnerable people.

1.19 If you know of anyone who would be interested in becoming a volunteer for the service please can you provide this link for them which gives you all

the information you need to know about being a [Surrey Fire Volunteer](http://www.surreyfirevolunteer.org). (www.surreyfirevolunteer.org)

COMMUNITY ENGAGEMENT

Education

- 1.20 The Services education team currently attends Special Educational Needs schools to deliver fire safety advice.

Number of Schools	Number of Pupils
2	44

Firewise Scheme

- 1.21 The Service has a successful referral scheme aimed at young people, who have shown an interest in fire setting.

Reigate & Banstead Borough	
Number of Referrals	6

Youth Engagement Scheme

- 1.22 Youth Engagement Scheme is an innovative scheme run by the Service with support from partners such as the youth support service, Brooklands College. (Public service tutors) The aim of the scheme is to divert young people from anti-social behavior and youth crime.

Reigate & Banstead Borough	
Total Number of Referrals	3
Total Number Offered Taster Session	3
Total Number Started	3
Total Number Graduated	2

Safe Drive Stay Alive

- 1.23 The Services main aim has always been to reduce the injuries and deaths of young people aged 16-25. This is achieving through various activities, mainly Safe Drive Stay Alive.

Reigate & Banstead Borough	
Number of Pupils	1069

WHAT HAPPENS NEXT

- 1.24 Members asked to support the Station(s) plan for 2013/2014
Members asked to recognise good performance by Reigate & Banstead personnel in 2012/2013

LEAD OFFICER: Eddie Roberts, Area Manager

TELEPHONE NUMBER: 01737 242444

E-MAIL: Eddie.roberts@surreycc.gov.uk

CONTACT OFFICER: Stuart de-Fraine Ford Station Manager –
Community Impact – East

TELEPHONE NUMBER: 01737 242444

E-MAIL: Stuart.defraineford@surreycc.gov.uk

BACKGROUND PAPERS: Reigate & Banstead Borough Plan 2012/2013
SFRS Public Safety Plan.

Web: www.surrey-fire.gov.uk

File Ref: Reigate & Banstead Borough Report April 2012-March 2013	Owner: SM Stuart de-Fraine Ford Community Impact East Area
Date of Issue: 06/09/2013	Version Number: 6
Consulted: Yes	

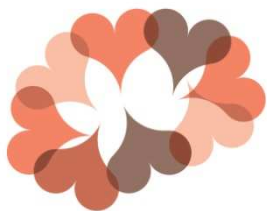

**Dementia
Friendly
Surrey**

DEMENTIA FRIENDLY SURREY

LIZ TRACEY

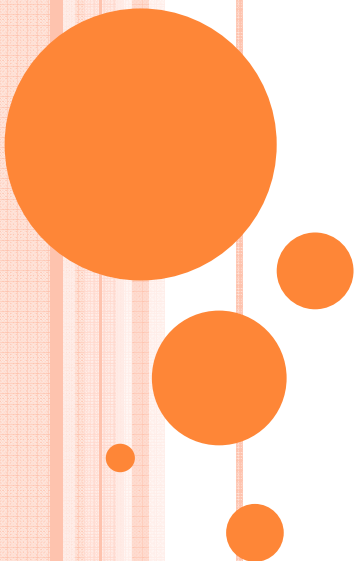

WHAT CARERS AND PEOPLE WITH DEMENTIA HAVE TOLD US THEY WANT

Affordable, welcoming and stimulating support groups and informal one-to-one support.

Opportunities to remain active and contribute to their community.

Greater public awareness.

Improvements to facilities and the physical environment such as dedicated parking bays for carers and more accessible toilets and changing rooms.



BECOMING DEMENTIA FRIENDLY MEANS...



HOW DO WE GET THERE?

Dementia Friendly Surrey Champions:
-working to become more dementia-friendly,
-encouraging others to do the same.



TRAINING

- Free of charge training for community groups, businesses, and other organisations.
- Understanding more about dementia, the challenges it brings and how we can help people with dementia in our community.
- Small businesses and national/global organisations such as Sainsbury's, Nationwide, NatWest and Barclays interested in training staff.



INNOVATION FUND

Bids for up to £5000.

Closing date 30 September

Dementia friendly gardens

Life story and reminiscence projects

Arts classes for people with early onset/ in early stages

IT and cookery classes – partnership between care home and voluntary sector

Information sessions with BME populations



COMMUNITY AWARENESS CAMPAIGN

To challenge the myths surrounding dementia and help people understand how they can make life better for individuals with dementia in their community.



RECOGNITION SCHEME

- A community (with an identified lead person) can register with the scheme.
- That community can issue the recognition logo to any business or organisation that demonstrates how they will become more dementia-friendly.
- Surrey is registered as a whole community.

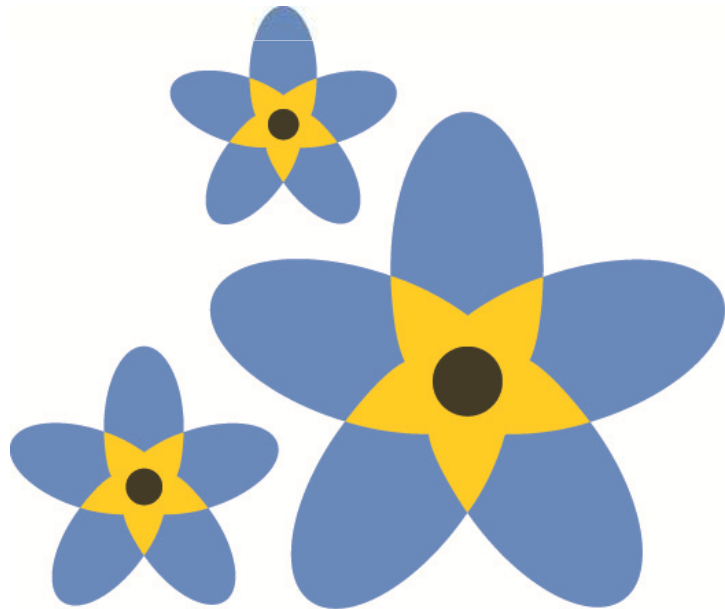

Working to become
**Dementia
Friendly**

PEER SUPPORT

- There are gaps in peer support across Surrey.
- 6 groups meet in Reigate and Banstead. Most meet once per month.
- Four are for carers only.

Filling gaps:

- Commissioning services.
- Supporting care homes, churches, community groups, former carers, and others to establish local groups.



CHAMPIONS

15 individuals and 35 groups/organisations/services county wide.

2 Champions from Reigate and Banstead.

Examples:

Dentist - North West Surrey

- Encouraging the wider community to become a dementia-friendly village. Links with business forum and other local groups used to set up community meeting.
- Ensuring staff are trained and encouraging other dental practices to train their staff.

Health Club- Guildford

- Offer a free exercise and nutrition session for people living with dementia and their carers.
- Provide myth busting information at regular coffee mornings.
- Provide myth busting information to members having a health check.



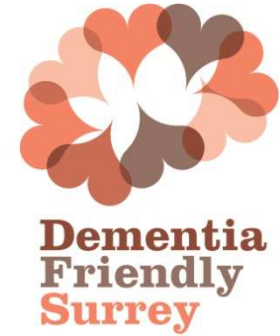

BENEFITS

Supporting people to live independently and safely at home resulting in reduction in avoidable admissions and less time needed in residential or hospital care.

Greater awareness - supporting increase in presentation to primary care and diagnosis rate.

Reduced social isolation and improved wellbeing of the person with dementia and carers.

Benefits for the wider community including older people, families with children, people with other disabilities.



This page is intentionally left blank